

N-PFHタイプ

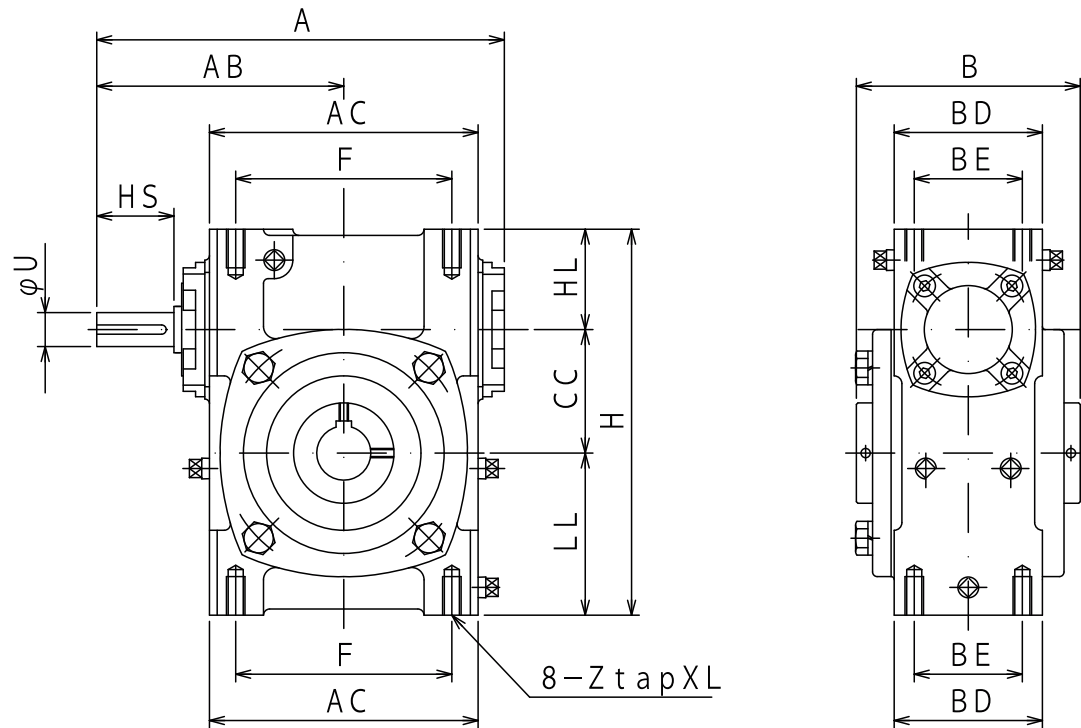
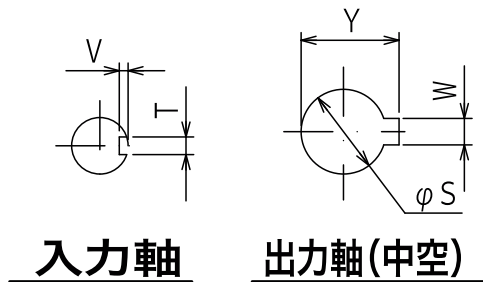

型番	A	AB	AC	B	BD	BE	CC	F	H	HL	LL	ZXL	入力軸				出力軸			重量 (kg)	油量 (L)
													HS	U	T	V	S	W	Y		
15	195	120	126	120	79	55	60	105	186	48	78	M8X20	40	15	5	3	25	8	28.3	10.0	0.4
18	234	140	155	130	88	65	70	125	215	55	90	M10X22	40	18	6	3.5	30	8	33.3	17.0	0.7
22	264	160	174	145	96	70	80	140	250	65	105	M12X25	50	22	6	3.5	35	10	38.3	21.0	1.1
25	322	190	224	175	116	90	100	180	310	80	130	M12X30	50	25	8	4	40	12	43.3	35.0	2.2
30	383	230	256	200	135	100	120	220	370	95	155	M16X30	65	30	8	4	45	14	48.8	65.0	3.2
35	432	260	296	210	148	110	135	260	425	105	185	M16X35	75	35	10	5	60	18	64.4	100	6.0
40	461	271	330	260	170	120	155	280	461	103	203	M16X30	75	40	12	5	70	20	74.9	120	9.3
45	545	325	370	334	186	140	175	320	521	123	223	M16X35	85	45	14	5.5	80	22	85.4	152	14.8