

# N-POタイプ

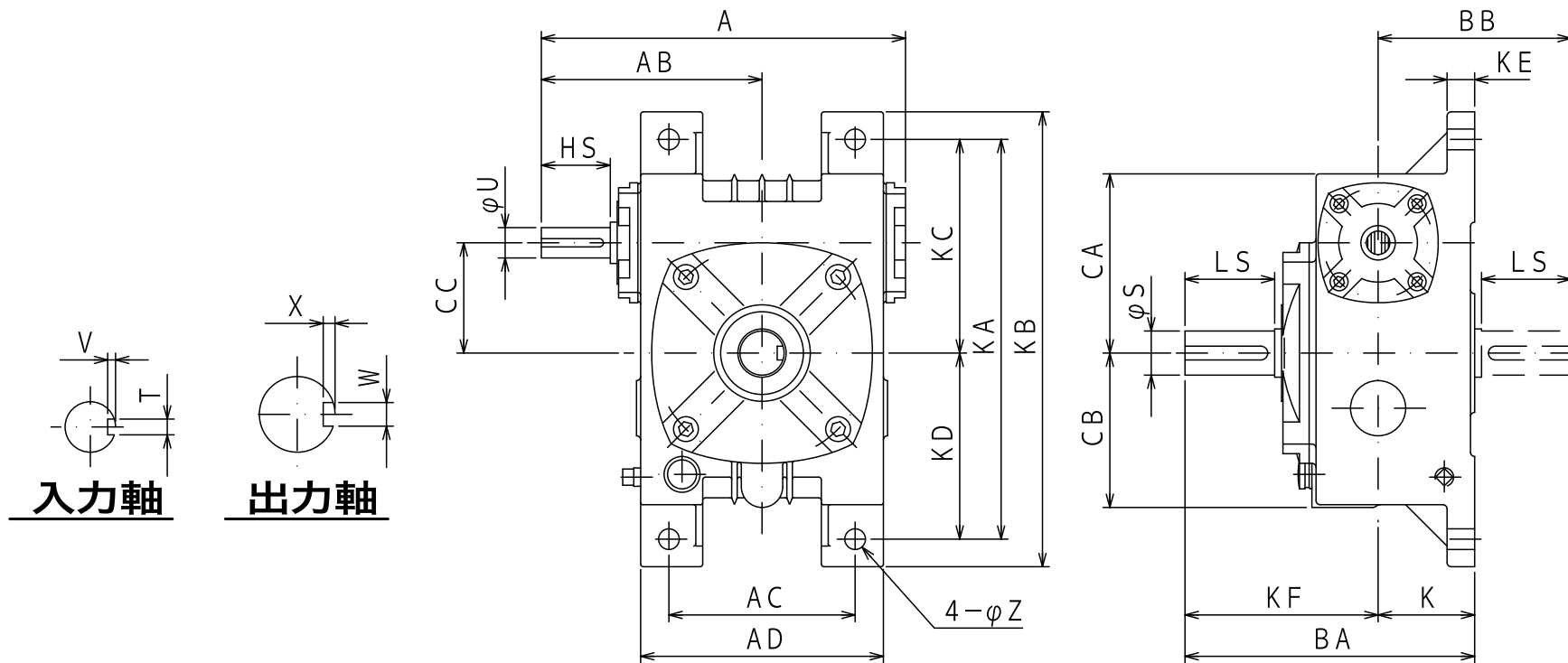

| 型番 | A   | AB  | AC  | AD  | BA  | BB  | CA  | CB  | CC  | KA  | KB  | KC  | KD  | KE | KF  | K   | Z  | 入力軸 |    |    |     | 出力軸 |    |    |     | 重量<br>(kg) | 油量<br>(L) |
|----|-----|-----|-----|-----|-----|-----|-----|-----|-----|-----|-----|-----|-----|----|-----|-----|----|-----|----|----|-----|-----|----|----|-----|------------|-----------|
|    |     |     |     |     |     |     |     |     |     |     |     |     |     |    |     |     |    | HS  | U  | T  | V   | LS  | S  | W  | X   |            |           |
| 12 | 175 | 105 | 90  | 116 | 145 | 95  | 87  | 78  | 50  | 195 | 220 | 102 | 93  | 14 | 95  | 50  | 11 | 30  | 12 | 4  | 2.5 | 40  | 17 | 5  | 3   | 6.9        | 0.4       |
| 15 | 195 | 120 | 95  | 125 | 165 | 110 | 100 | 90  | 60  | 230 | 260 | 120 | 110 | 20 | 110 | 55  | 11 | 40  | 15 | 5  | 3   | 50  | 22 | 6  | 3.5 | 10.1       | 0.6       |
| 18 | 234 | 140 | 115 | 155 | 195 | 130 | 115 | 100 | 70  | 265 | 305 | 140 | 125 | 20 | 130 | 65  | 15 | 40  | 18 | 6  | 3.5 | 60  | 28 | 8  | 4   | 15.7       | 1.2       |
| 22 | 264 | 160 | 135 | 176 | 210 | 140 | 130 | 110 | 80  | 290 | 330 | 155 | 135 | 20 | 140 | 70  | 15 | 50  | 22 | 6  | 3.5 | 65  | 32 | 10 | 5   | 21.6       | 1.6       |
| 25 | 322 | 190 | 190 | 225 | 260 | 170 | 160 | 140 | 100 | 350 | 390 | 185 | 165 | 30 | 170 | 90  | 15 | 50  | 25 | 8  | 4   | 75  | 38 | 10 | 5   | 45.5       | 3.4       |
| 30 | 383 | 230 | 210 | 255 | 290 | 190 | 190 | 165 | 120 | 405 | 460 | 215 | 190 | 30 | 190 | 100 | 18 | 65  | 30 | 8  | 4   | 85  | 45 | 14 | 5.5 | 65.5       | 5.2       |
| 35 | 432 | 260 | 260 | 297 | 315 | 210 | 205 | 175 | 135 | 450 | 500 | 240 | 210 | 30 | 210 | 105 | 18 | 75  | 35 | 10 | 5   | 95  | 55 | 16 | 6   | 83.7       | 6.7       |
| 40 | 461 | 271 | 280 | 330 | 370 | 240 | -   | -   | 155 | 395 | 445 | 255 | 140 | 30 | 240 | 130 | 21 | 75  | 40 | 12 | 5   | 110 | 60 | 18 | 7   | 114        | 7.0       |
| 45 | 536 | 316 | 330 | 380 | 420 | 270 | -   | -   | 180 | 450 | 500 | 285 | 165 | 35 | 270 | 150 | 21 | 90  | 45 | 14 | 5.5 | 120 | 65 | 18 | 7   | 164        | 11.0      |
| 50 | 637 | 376 | 400 | 460 | 485 | 315 | -   | -   | 220 | 530 | 590 | 330 | 200 | 35 | 315 | 170 | 24 | 110 | 50 | 14 | 5.5 | 140 | 75 | 20 | 7.5 | 253        | 20.0      |